

ORDINANCE NO. 3625

AN ORDINANCE AMENDING ORDINANCE NO. 352, THE ZONING ORDINANCE OF TULARE COUNTY, BEING AN ORDINANCE ESTABLISHING AND REGULATING LAND USES WITHIN CERTAIN ZONES IN THE COUNTY OF TULARE.

THE BOARD OF SUPERVISORS OF THE COUNTY OF TULARE DO ORDAIN AS FOLLOWS:

Section 1. Paragraph B of Section 3 of Ordinance No. 352 of the County of Tulare is hereby amended by the adoption of an amended map of a portion of Section 12, Township 19 South, Range 24 East, Mount Diablo Base and Meridian, being a subdivision of Part 281 of the Official Zoning Maps. A map showing Change of Zone No. PZC 22-011 approved for approximately 0.57 acres (25,034.75 square feet) is attached hereto and incorporated herein by reference. The new zoning will be C-2-MU (General Commercial with a Mixed-Use Overlay Combining Zone).

Section 2. The property affected by the zoning reclassification from AE-20 (Exclusive Agricultural – 20 Acre Minimum Zone), is briefly described as follows: Being a 0.57-acre (25,034.75 square foot) parcel, located on Tulare County Assessor Parcel Number (APN) 126-390-018. The subject property is located at 27210 Road 108, on the northeast corner of Avenue 271 and Road 108 (South Demaree Street), in the unincorporated area of Tulare County approximately 0.33 miles south of the City of Visalia.

Section 3. This Ordinance shall take effect thirty (30) days from the date of the passage hereof, or if published more than 15 days after the date of passage, then 30 days after publication, whichever is later, and, shall be published once in The Sun-Gazette, a newspaper printed and published in the County of Tulare, State of California, together with the names of the members of the Board of Supervisors voting for and against the same.

THE FOREGOING ORDINANCE was passed and adopted by the Board of Supervisors of the County of Tulare, State of California, on the 16TH day of May 2023, at a regular meeting of said Board, duly and regularly convened on said day, by the following roll call vote:

AYES: SUPERVISORS MICARI, VANDER POEL, SHUKLIAN, VALERO AND
TOWNSEND
NOES: NONE
ABSENT: NONE



Chair, Board of Supervisors

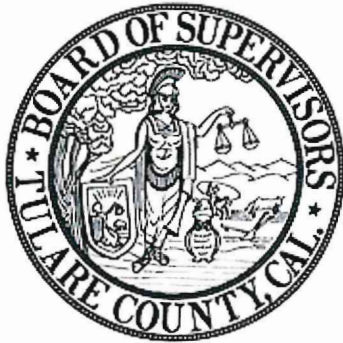

ATTEST: Jason T. Britt

County Administrative Officer/Clerk
Board of Supervisors

By: 
Deputy Clerk

Approved as to Form:



Deputy County Counsel
Matter No. RMA General

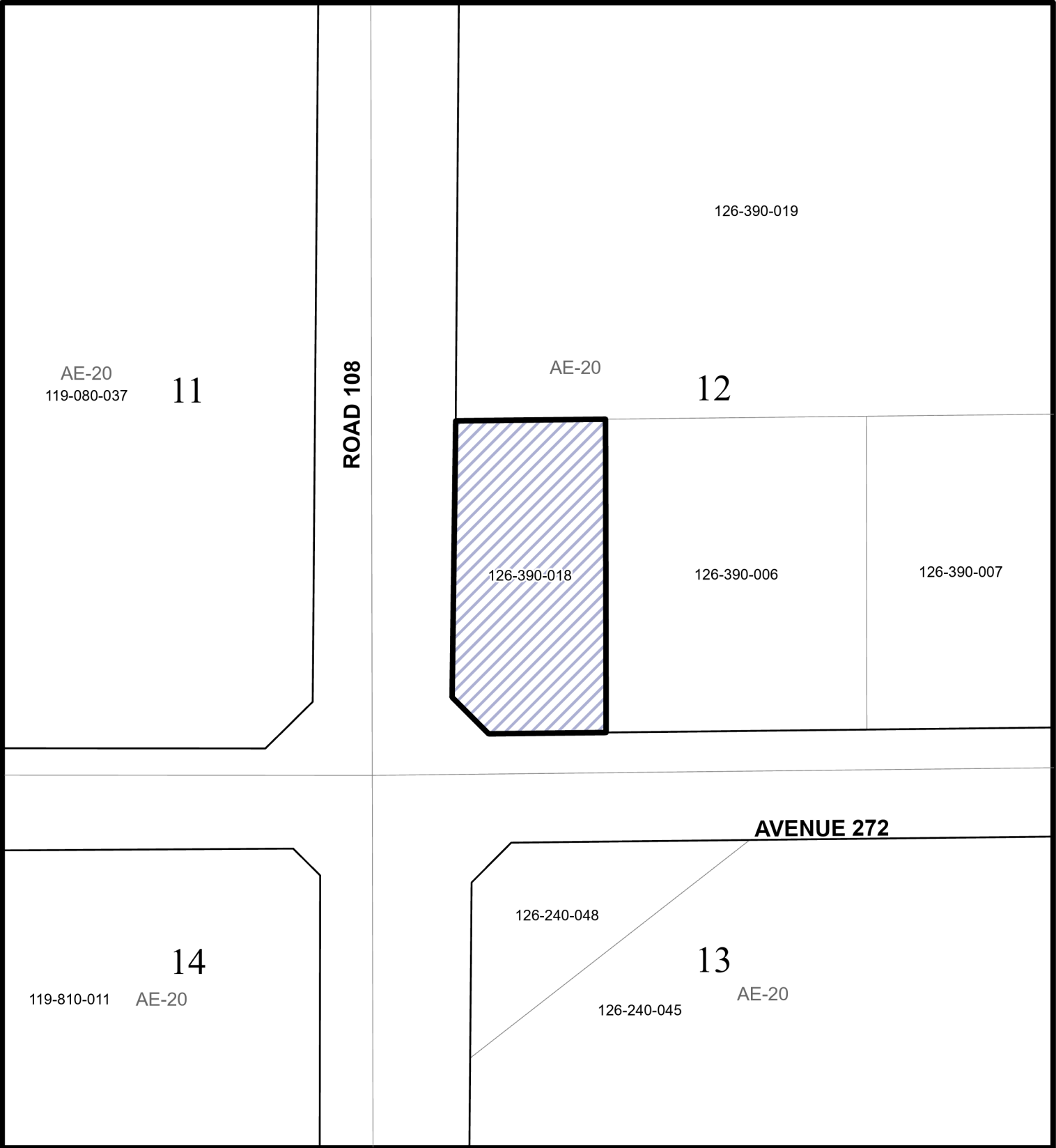

APN: 126-390-018
APROX. 0.5 ac
Zone Change from AE-20 (Exclusive Agricultural -
20 Acre Minimum) to C-2-MU (General Commercial
with a Mixed-Use Overlay Combining)
(PZC 22-011)

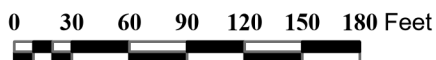

ORDINANCE NO. 3625
AMENDING A PORTION OF MAP PART 281,
PART OF SEC. 12, T 19 S, R 24 E, M.D.B.& M.
OF
OFFICIAL ZONING MAP
COUNTY OF TULARE, CA.

TULARE COUNTY BOARD OF SUPERVISORS
ADOPTED: 5 / 16 /2023