

ORDINANCE NO. 3651

AN ORDINANCE AMENDING ORDINANCE NO. 352, THE ZONING ORDINANCE OF TULARE COUNTY, ESTABLISHING AND REGULATING LAND USES WITHIN CERTAIN ZONES IN THE COUNTY OF TULARE.

THE BOARD OF SUPERVISORS OF THE COUNTY OF TULARE DO ORDAIN AS FOLLOWS:

Section 1. Paragraph B of Section 3 of Ordinance No. 352 of the County of Tulare is hereby amended by the adoption of an amended map of a portion of Section 3, Township 19 South, Range 26 East, Mount Diablo Base and Meridian, being a subdivision of Part 322 of the Official Zoning Maps. A map showing Change of Zone No. PZC 24-006 approved for approximately 9.39 acres is attached hereto and incorporated herein by reference. The new zoning will be R-A-43 (Rural Residential – 43,000 square foot minimum).

Section 2. The property affected by the zoning reclassification from A-1 (Agriculture) Zone, is briefly described as follows: Being two (2) parcels totaling 9.39-acres, located on Tulare County Assessor Parcel Numbers (APNs) 138-010-064 and 138-010-092. The subject property is within the Exeter Urban Development Boundary, on the east side of Belmont Road (Road 198) and approximately 1,000 feet north of Meadow Avenue.

Section 3. This Ordinance shall take effect thirty (30) days from the date of the passage hereof, or if published more than 15 days after the date of passage, then 30 days after publication, whichever is later, and shall be published once in a newspaper of general circulation within the County of Tulare, State of California, together with the names of the members of the Board of Supervisors voting for and against the same.

THE FOREGOING ORDINANCE was passed and adopted by the Board of Supervisors of the County of Tulare, State of California, on the 28th day of January, 2025, at a regular meeting of said Board, duly and regularly convened on said day, by the following roll call vote:

AYES: SUPERVISORS MICARI, VANDER POEL, SHUKLIAN, VALERO AND TOWNSEND

NOES: NONE

ABSTAIN: NONE

ABSENT: NONE



Chair, Board of Supervisors

Approved as to Form:



Deputy County Counsel
Matter No. rma-general

ATTEST: Jason T. Britt
County Administrative Officer/Clerk
Board of Supervisors

By: 

Deputy Clerk



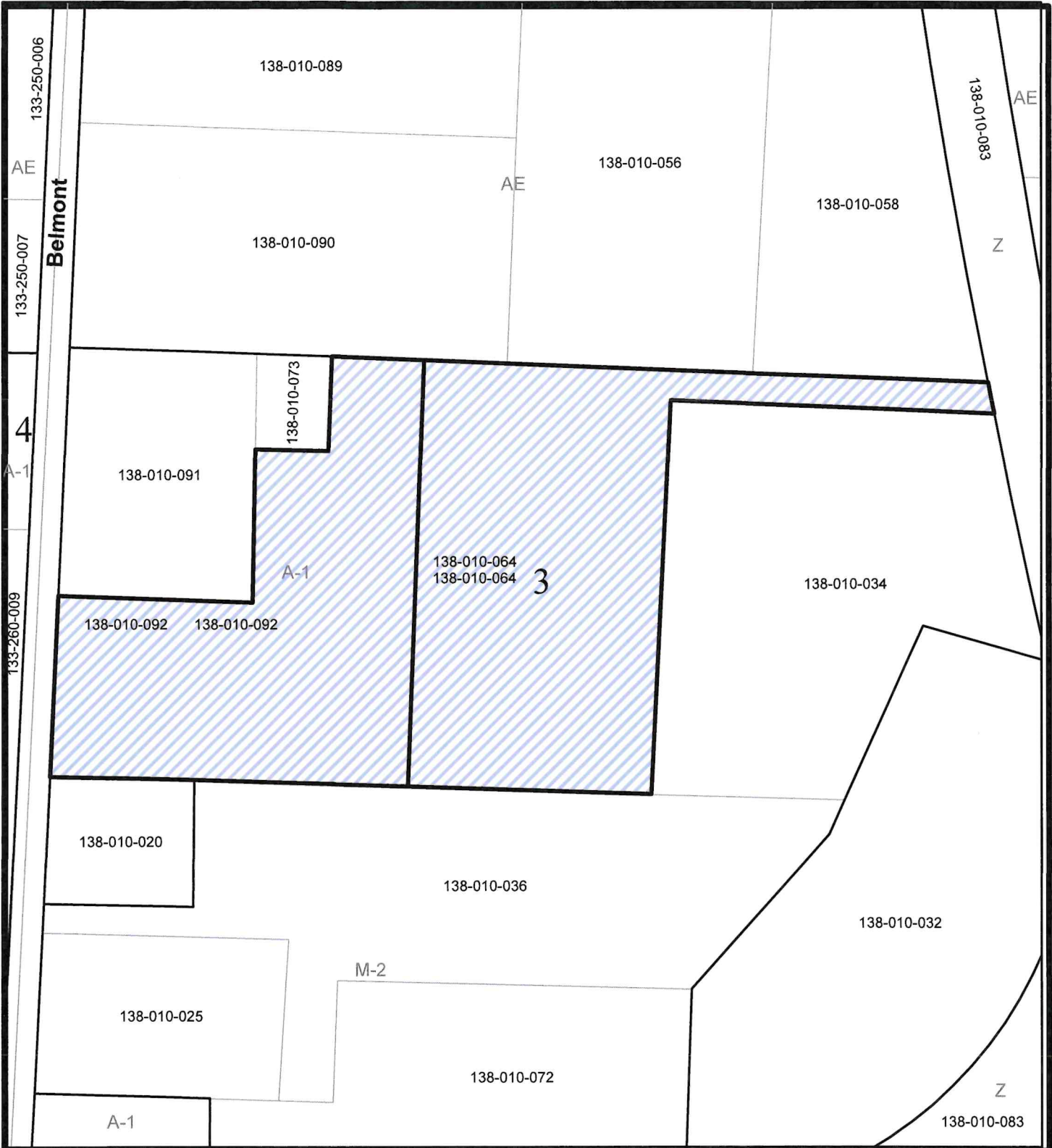

APN: 138-010-064 and 092
APROX. 9.39 AC.

Zone Change from A-1 (Agricultural) to R-A-43
(Rural Residential - 43,000 Sqft Minimum)

(PZC 24-006)

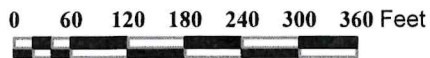

ORDINANCE NO. **3651**

AMENDING A PORTION OF MAP PART 322,
PART OF SEC. 3, T 19 S, R 26 E, M.D.B. & M.
OF

**OFFICIAL ZONING MAP
COUNTY OF TULARE, CA.**

TULARE COUNTY BOARD OF SUPERVISORS

ADOPTED: **1 / 28 / 2025**