

ORDINANCE NO. 3631

AN ORDINANCE AMENDING ORDINANCE NO. 352, THE ZONING ORDINANCE OF TULARE COUNTY, BEING AN ORDINANCE ESTABLISHING AND REGULATING LAND USES WITHIN CERTAIN ZONES IN THE COUNTY OF TULARE.

THE BOARD OF SUPERVISORS OF THE COUNTY OF TULARE DO ORDAIN AS FOLLOWS:

Section 1. Paragraph B of Section 3 of Ordinance No. 352 of the County of Tulare is hereby amended by the adoption of an amended map of a portion of Section 33, Township 18 South, Range 26 East, Mount Diablo Base and Meridian, being a subdivision of Part 424 of the Official Zoning Maps. A map showing Change of Zone No. PZC 22-009 approved for approximately 10.00 acres is attached hereto and incorporated herein by reference. The new zoning will be AE (Exclusive Agriculture).

Section 2. The property affected by the zoning reclassification from AE-40 (Exclusive Agriculture – 40 Acre Minimum), is briefly described as follows: Being a 10.00-acre parcel, located on Tulare County Assessor Parcel Number (APN) 111-240-024. The subject property is within the Rural Valley Lands Plan, at 3162 N. Anderson Road, on the east side of Anderson Road, and approximately 800 feet south of State Route 198, north of Exeter.

Section 3. This Ordinance shall take effect thirty (30) days from the date of the passage hereof, or if published more than 15 days after the date of passage, then 30 days after publication, whichever is later, and, shall be published once in The Sun-Gazette, a newspaper printed and published in the County of Tulare, State of California, together with the names of the members of the Board of Supervisors voting for and against the same.

THE FOREGOING ORDINANCE was passed and adopted by the Board of Supervisors of the County of Tulare, State of California, on the 3rd day of October 2023, at a regular meeting of said Board, duly and regularly convened on said day, by the following roll call vote:

AYES: SUPERVISORS MICARI, VANDER POEL, SHUKLIAN, VALERO AND TOWNSEND

NOES: NONE

ABSTAIN: NONE

ABSENT: NONE

  
Chairman, Board of Supervisors

Approved as to Form:

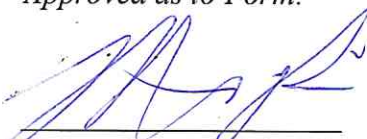
  
Deputy County Counsel

ATTEST: Jason T. Britt  
County Administrative Officer/Clerk  
Board of Supervisors

By:   
Deputy Clerk



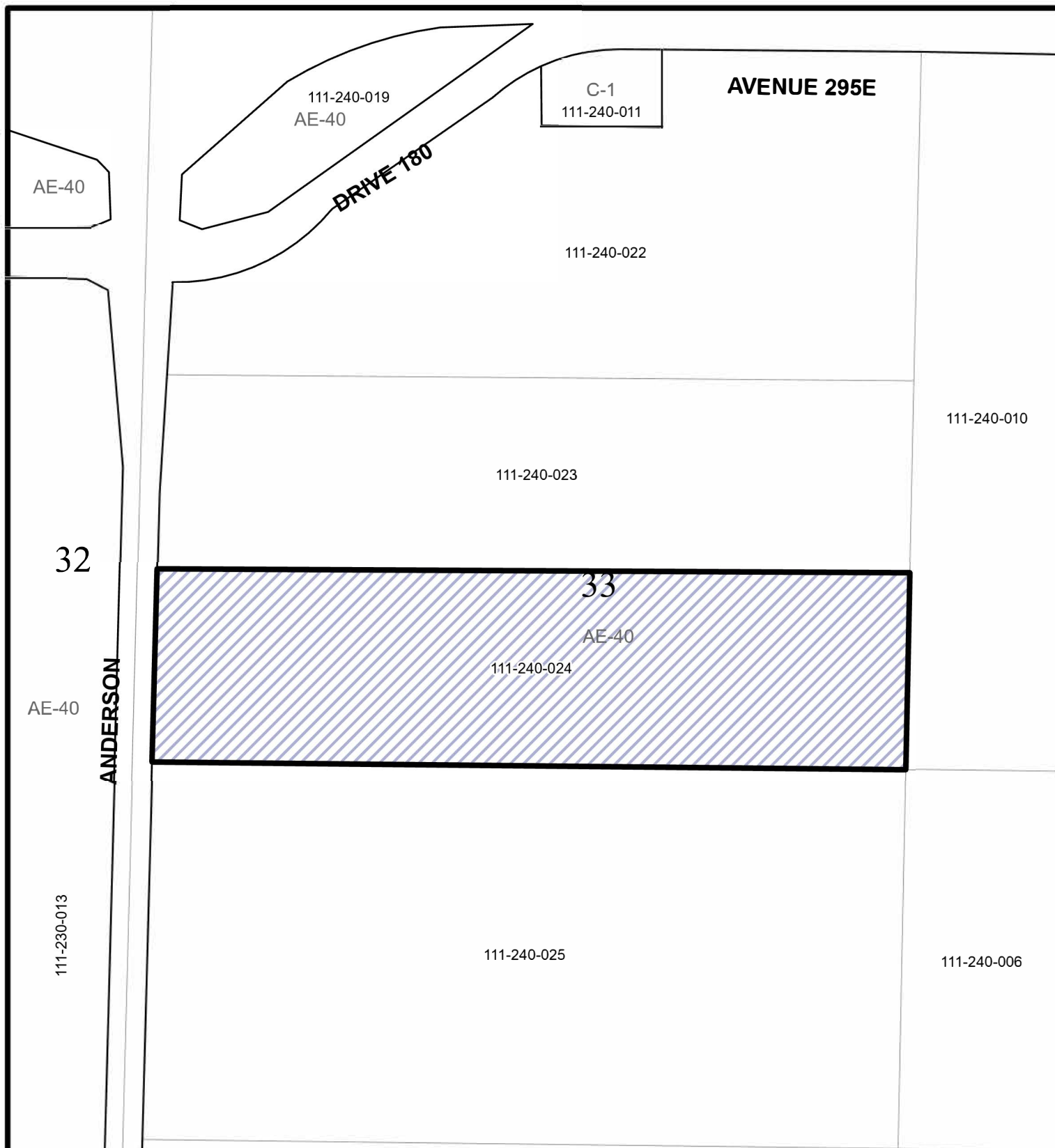

APN: 111-240-024

APROX. 10 ac

Zone Change from AE-40 (Exclusive Agricultural  
-40 Acre Minimum) to AE (Exclusive Agriculture)  
(PZC 22-009)

N

0 75 150 225 300 375 450 Feet



ORDINANCE NO. 3631  
AMENDING A PORTION OF MAP PART 424,  
PART OF SEC. 33, T 18 S, R 26 E, M.D.B. & M.  
OF

**OFFICIAL ZONING MAP  
COUNTY OF TULARE, CA.**

TULARE COUNTY BOARD OF SUPERVISORS  
ADOPTED: 10 / 3 / 2023